

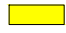

	EXISTING GRAVEL AREA		EXISTING CATCH BASIN
	EXISTING SPEED BUMPS		STEEL BOLLARDS
	PROPOSED CONCRETE RAMP		HANDICAP PARKING



**IRC BUILDING SCIENCES GROUP**  
 SERVING CANADA WITH REGIONAL OFFICES FROM COAST TO COAST  
 HEAD OFFICE  
 2121 ARGENTIA ROAD, SUITE 401, MISSISSAUGA, ONTARIO  
 TOLL FREE: 1-888-607-5245 TEL: 905-607-7244  
 WWW.IRCGROUP.COM FAX: 905-607-7288

**TITLE:** SITE PLAN  
**CLIENT:** HOUSING SERVICES CORPORATION  
**PROJECT:** WESTWOOD PLACE  
 6550 & 6600 KALAR RD.  
 NIAGARA FALLS, ONTARIO

**IRC #:** 08621  
**W.O.#:** HA18-178SP  
**SCALE:** N.T.S.  
**DATE:** JANUARY 2019

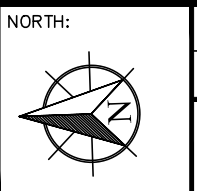

**DRN.:** R.P.  
**CHK.:** M.M.  
**DWG.#:** D1

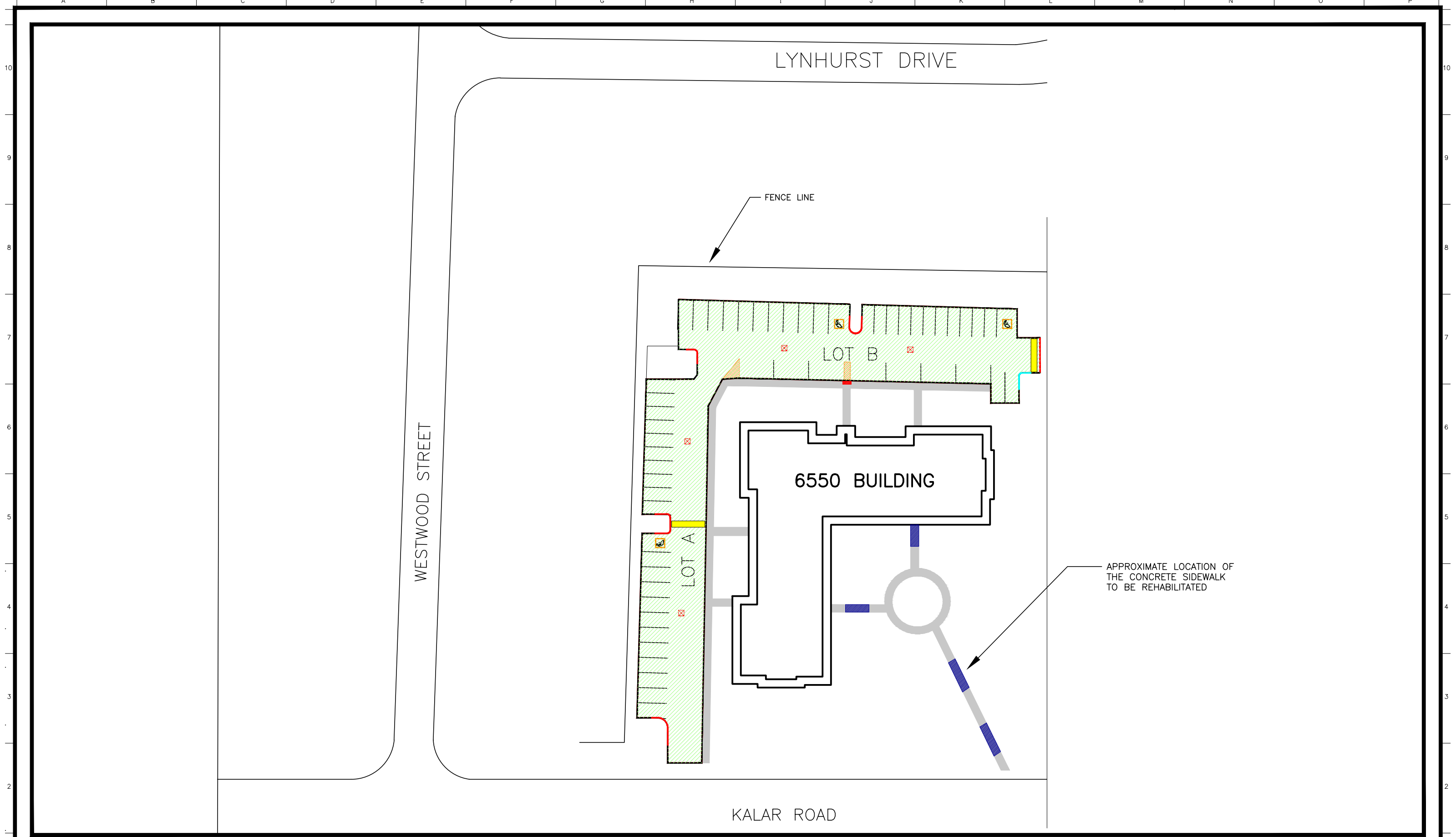

	PROPOSED REHABILITATION ASPHALT AREA (2019)		PROPOSED CONCRETE RAMP
	PROPOSED NEW CONCRETE SIDEWALK		HANDICAP PARKING
	PROPOSED NEW CONCRETE CURBS		EXISTING CATCH BASIN
	EXISTING SPEED BUMPS		



**IRC BUILDING SCIENCES GROUP**  
 SERVING CANADA WITH REGIONAL OFFICES FROM COAST TO COAST  
 HEAD OFFICE  
 2121 ARGENTIA ROAD, SUITE 401, MISSISSAUGA, ONTARIO  
 TOLL FREE: 1-888-607-5245 TEL: 905-607-7244  
 WWW.IRCGROUP.COM FAX: 905-607-7288

TITLE:	PROPOSED LOT A & B
CLIENT:	HOUSING SERVICES CORPORATION
PROJECT:	WESTWOOD PLACE 6550 KALAR RD. NIAGARA FALLS, ONTARIO

IRC #:	08621
W.O.#:	HA18-178SP
SCALE:	N.T.S.
DATE:	JANUARY 2019

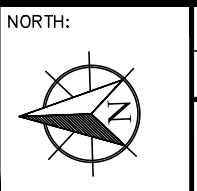







DRN.:	R.P.
CHK.:	M.M.
DWG.#:	D2

LYNHURST DRIVE

KALAR ROAD

6600 BUILDING

APPROXIMATE LOCATION  
OF THE PROPOSED  
TWO (2) NEW BOLLARDS

	PROPOSED REHABILITATION ASPHALT AREA (2019)		EXISTING CATCH BASIN
	PROPOSED NEW CONCRETE CURBS		STEEL BOLLARDS
	EXISTING SPEED BUMPS		HANDICAP PARKING



**IRC BUILDING SCIENCES GROUP**  
SERVING CANADA WITH REGIONAL OFFICES FROM COAST TO COAST  
HEAD OFFICE  
2121 ARGENTIA ROAD, SUITE 401, MISSISSAUGA, ONTARIO  
TOLL FREE: 1-888-607-5245 TEL: 905-607-7244  
WWW.IRCGROUP.COM FAX: 905-607-7288

TITLE: PROPOSED LOT C, D & E  
CLIENT: HOUSING SERVICES CORPORATION  
PROJECT: WESTWOOD PLACE  
6600 KALAR RD.  
NIAGARA FALLS, ONTARIO

IRC #: 08621  
W.O.#: HA18-178SP  
SCALE: N.T.S.  
DATE: JANUARY 2019

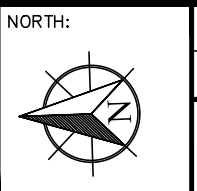

DRN.: R.P.  
CHK.: M.M  
DWG.#: D3

APPROXIMATE LOCATION  
OF THE PROPOSED  
STOP SIGN

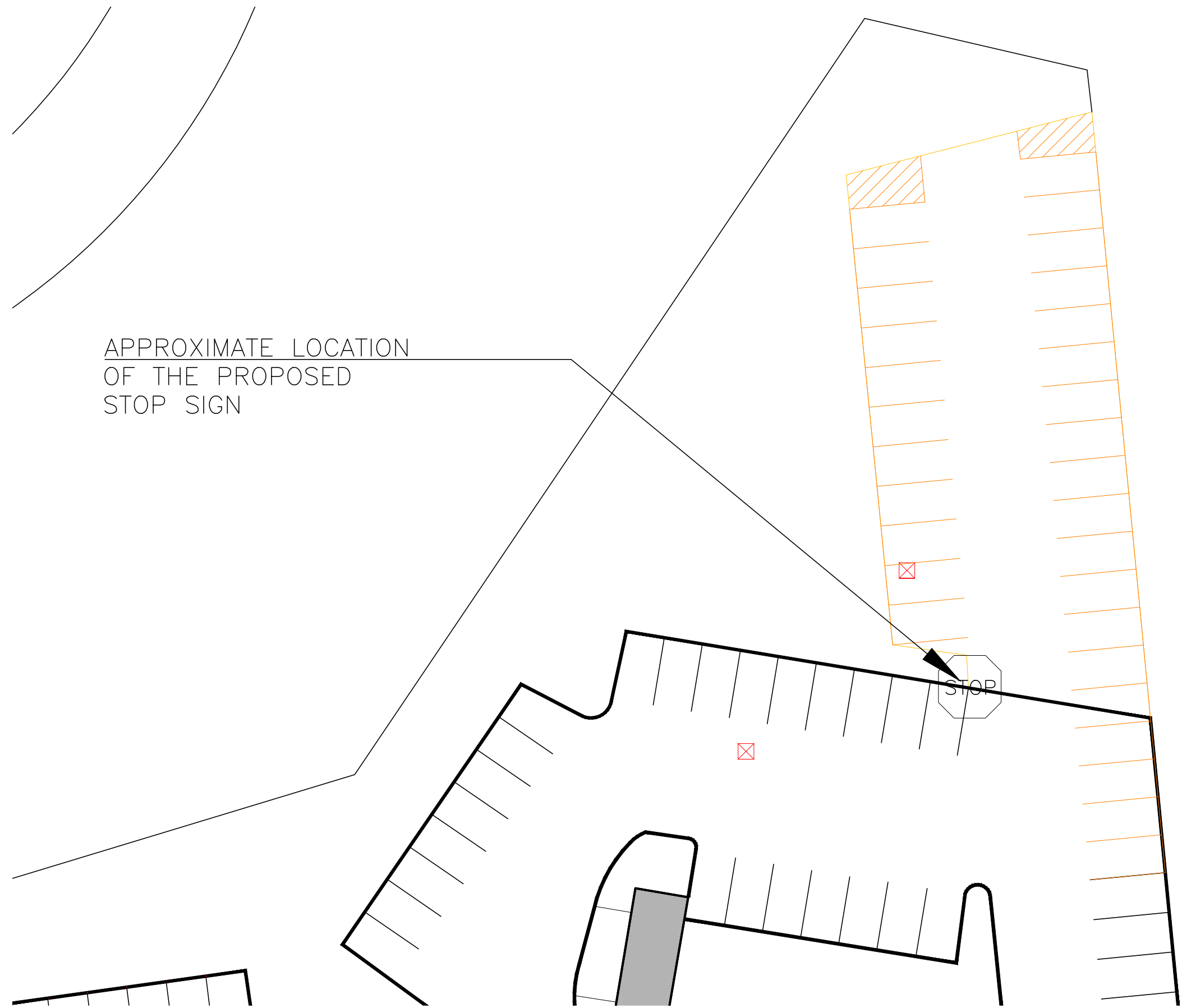

	PROPOSED SPEED BUMP
	EXISTING CATCH BASIN



**IRC BUILDING SCIENCES GROUP**  
SERVING CANADA WITH REGIONAL OFFICES FROM COAST TO COAST  
HEAD OFFICE  
2121 ARGENTIA ROAD, SUITE 401, MISSISSAUGA, ONTARIO  
TOLL FREE: 1-888-607-5245 TEL: 905-607-7244  
WWW.IRCGROUP.COM FAX: 905-607-7288

TITLE: PROPOSED GRAVEL EXPANSION  
CLIENT: HOUSING SERVICES CORPORATION  
PROJECT: WESTWOOD PLACE  
6600 KALAR RD.  
NIAGARA FALLS, ONTARIO

IRC #: 08621  
W.O.#: HA18-178SP  
SCALE: N.T.S.  
DATE: JANUARY 2019

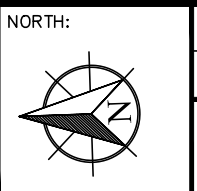

DRN.: R.P.  
CHK.: M.M.  
DWG.#: D4

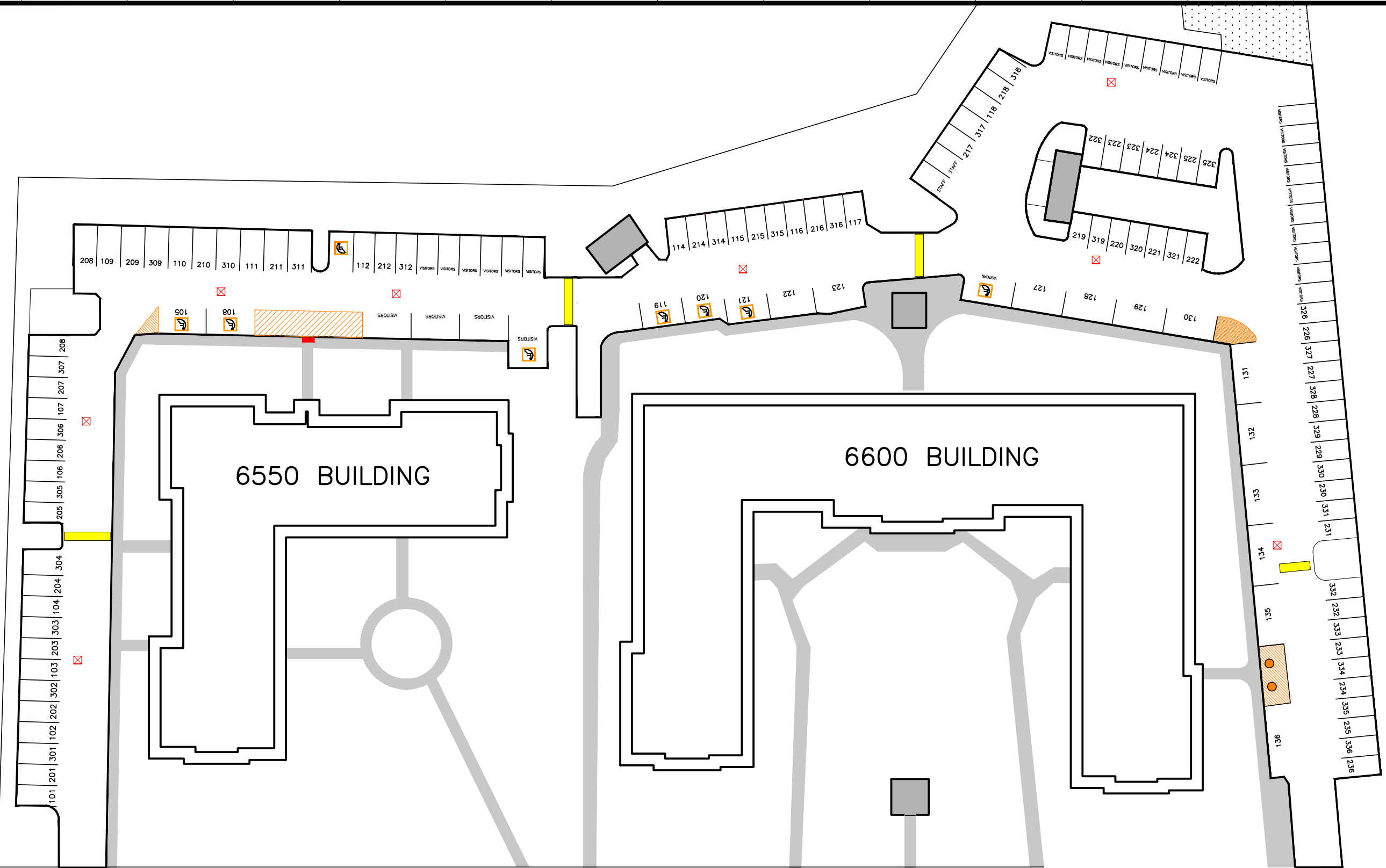

KALAR ROAD

EXISTING CATCH BASIN



**IRC BUILDING SCIENCES GROUP**  
 SERVING CANADA WITH REGIONAL OFFICES FROM COAST TO COAST  
 HEAD OFFICE  
 2121 ARGENTIA ROAD, SUITE 401, MISSISSAUGA, ONTARIO  
 TOLL FREE: 1-888-607-5245 TEL: 905-607-7244  
 WWW.IRCGROUP.COM FAX: 905-607-7288

TITLE: SITE PLAN  
 CLIENT: HOUSING SERVICES CORPORATION  
 PROJECT: WESTWOOD PLACE  
 6600 KALAR RD.  
 NIAGARA FALLS, ONTARIO

IRC #: 08621  
 W.O.#: HA18-178SP  
 SCALE: N.T.S.  
 DATE: JANUARY 2019

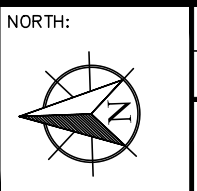

DRN.: R.P.  
 CHK.: M.M.  
 DWG.#: D5

\\IRC-PR-FST\USERS\RLAUGHLIN\DESKTOP\X-SECTION DETAILS\CAD DETAILS\2AC07\_MODIFIED.DWG

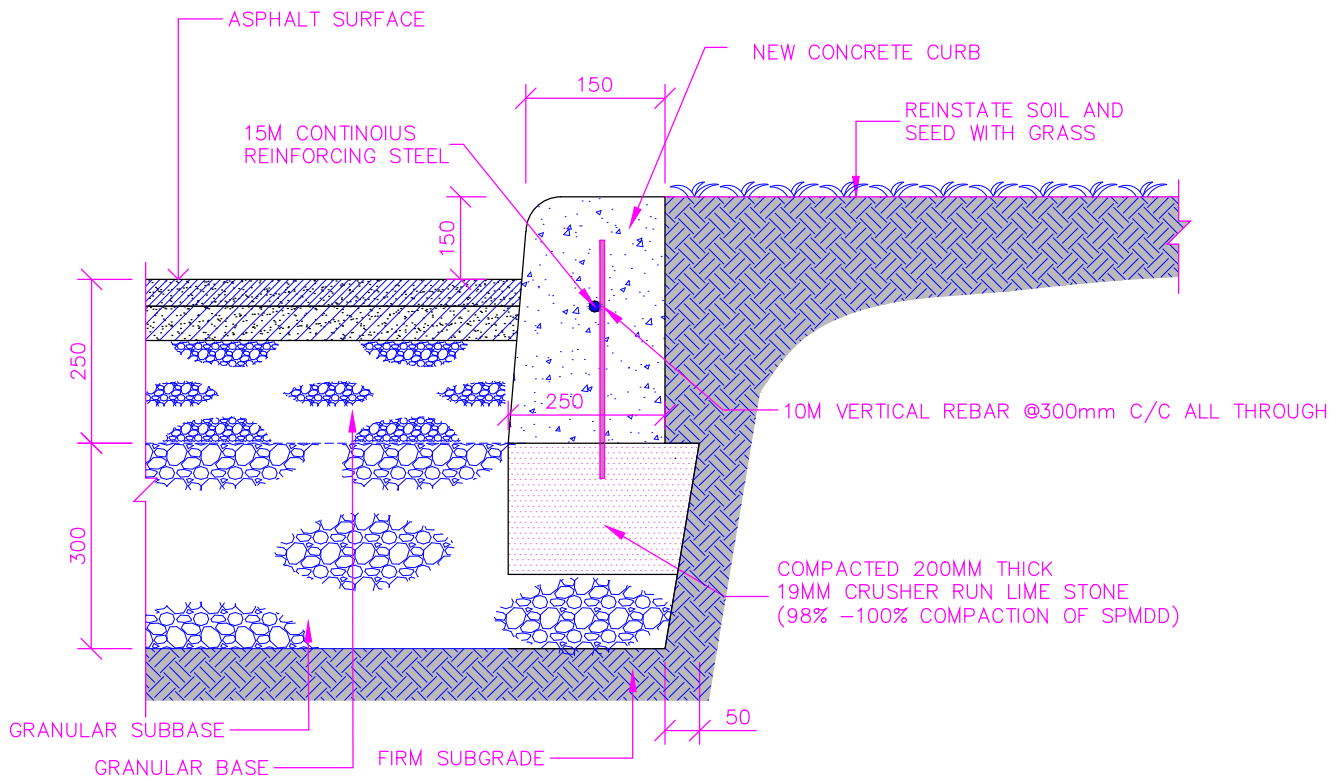

TITLE: NEW CONCRETE CURB DETAIL

IRC #: —

SCALE: N.T.S.

W.O. #: —

DATE: NOV. 18/2015

NOTE: NO REPRODUCTION OR USE OF THIS DRAWING IS AUTHORIZED WITHOUT EXPRESSED WRITTEN CONSENT ©COPYRIGHT 2009 IRC BUILDING SCIENCES GROUP INC.

DRN. BY: M.H.

DWG.#: 2AC07

CHK. BY: M.M.

M:\ADMIN\BUILDINGSCIENCE\DETAILS\2\_PARKING\_REHABILITATION\AC ASPHALT CONC\2AC09.DWG

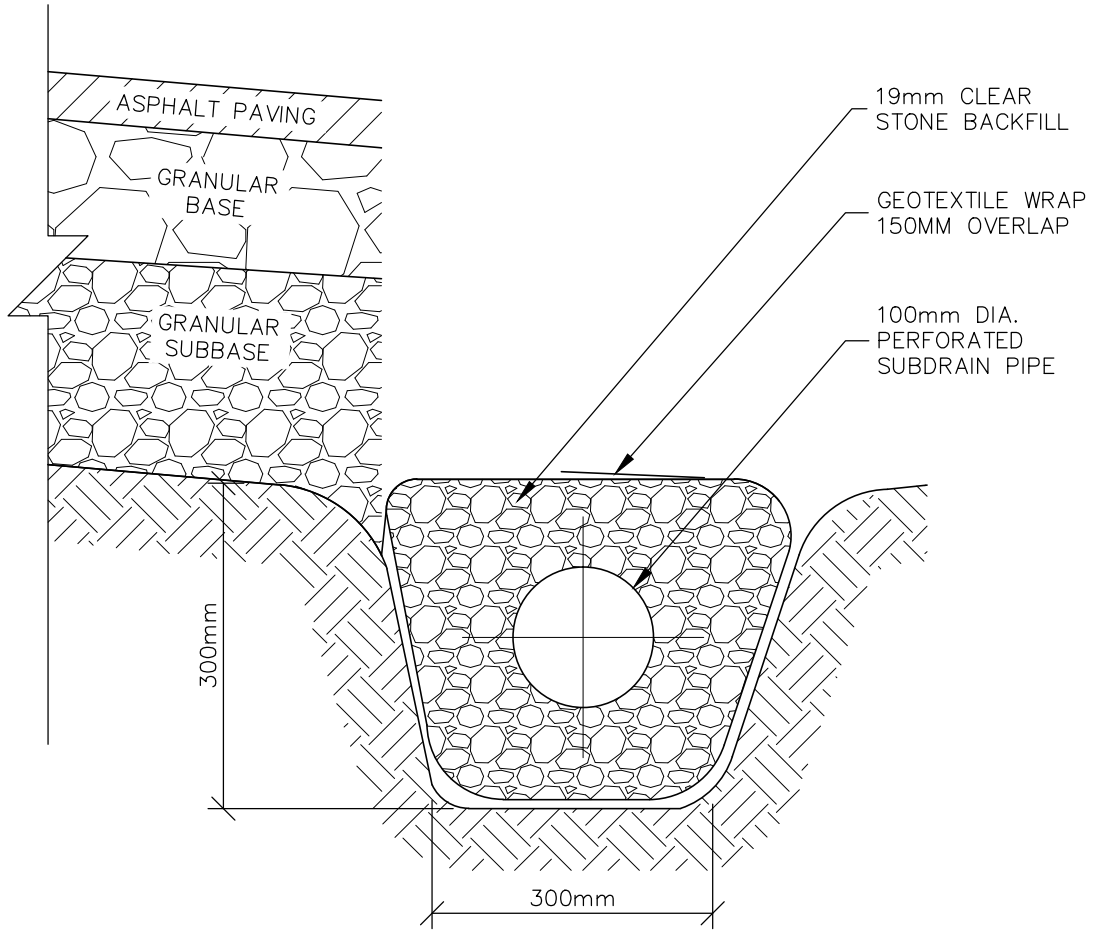

SECTION DETAIL  
PAVEMENT SUBDRAIN

SCALE: N.T.S.

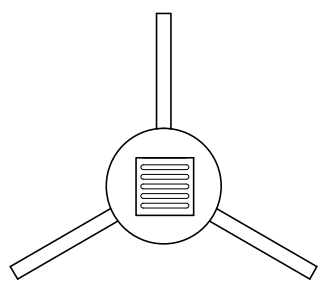

PLAN DETAIL  
AREA CATCH BASIN  
SCALE: N.T.S.

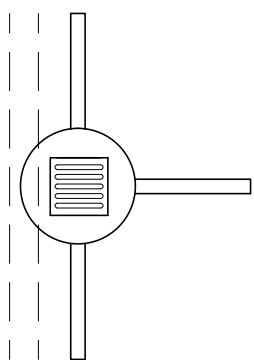

PLAN DETAIL  
CATCH BASIN AT CRUB  
SCALE: N.T.S.

- NOTES:
1. PLACE 100mm DIAMETER PERFORATED SUBDRAIN PIPE SURROUNDED BY 20mm CLEAR CRUSHED STONE AND WRAPPED IN FILTER CLOTH.
  2. SUBDRAINS TO BE INSTALLED AT MINIMUM 0.5 PERCENT GRADE AND CONNECT TO POSITIVE OUTLET (I.E. DITCH OR CATCHBASIN); UNIT PRICE TO INCLUDE TEE CONNECTIONS.



<p>NOTE: NO REPRODUCTION OR USE OF THIS DRAWING IS AUTHORIZED WITHOUT EXPRESSED WRITTEN CONSENT ©COPYRIGHT 2015 IRC BUILDING SCIENCES GROUP INC.</p>	<p>TITLE: NEW SUBDRAIN DETAIL</p>	<p>IRC #: —</p>	<p>SCALE: N.T.S.</p>
		<p>W.O. #: —</p>	<p>DATE: JAN. 09/15</p>
		<p>DRN. BY: C.N.P.</p>	<p>DWG.#: 2AC09</p>
		<p>CHK. BY: M.M.</p>	

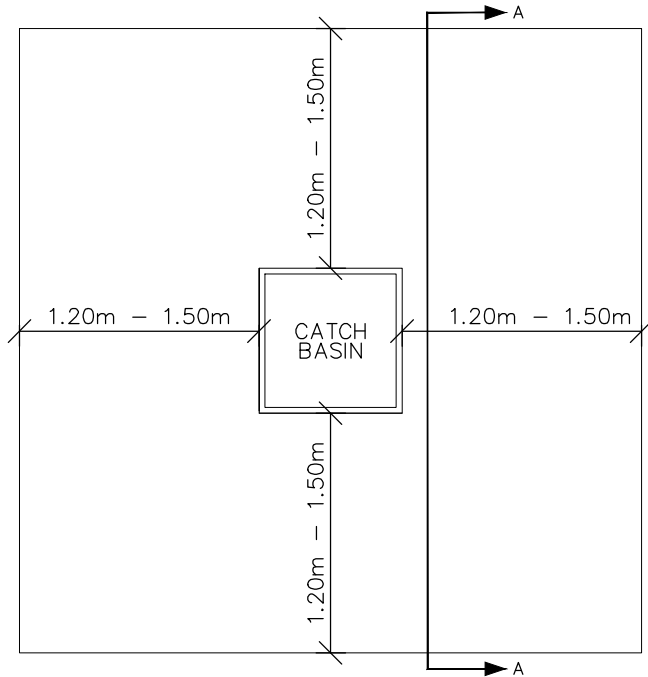

PLAN DETAIL  
FROST TREATMENT AREA

SCALE: N.T.S.

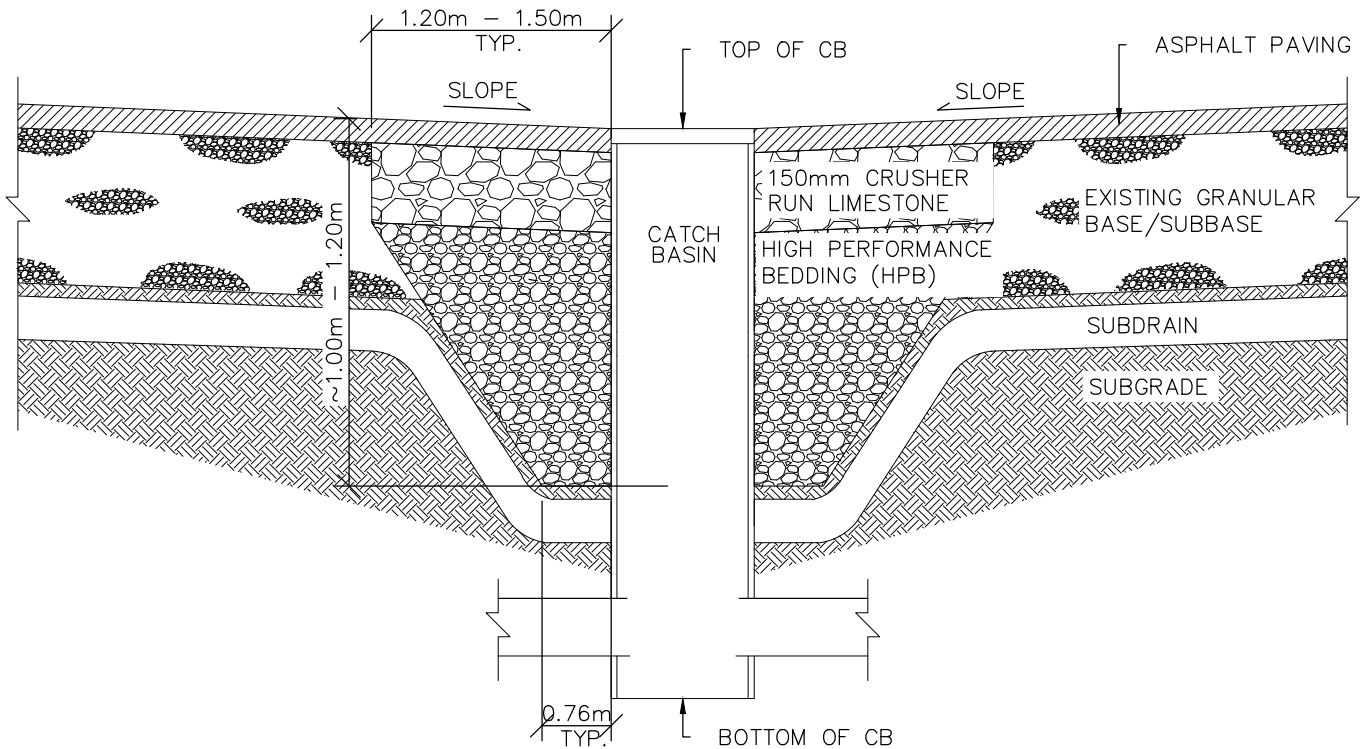

SECTION A - A DETAIL  
FROST TREATMENT AREA

SCALE: N.T.S.

M:\ADMIN\BUILDINGSCIENCE\DETAILS\2\_PARKING\_REHABILITATION\AC ASPHALT\_CONC\2AC10.DWG



TITLE: CATCHBASIN FROST  
TREATMENT DETAIL

NOTE: NO REPRODUCTION OR USE OF THIS DRAWING IS  
AUTHORIZED WITHOUT EXPRESSED WRITTEN CONSENT  
©COPYRIGHT 2015 IRC BUILDING SCIENCES GROUP INC.

IRC #: —

W.O. #: —

DRN. BY: C.N.P.

CHK. BY: M.M.

SCALE: N.T.S.

DATE: JAN. 09/15

DWG.#:  
2AC10



M:\ADMIN\BUILDINGSCIENCE\DETAILS\2\_PARKING\_REHABILITATION\AC ASPHALT CONC\2AC11.DWG

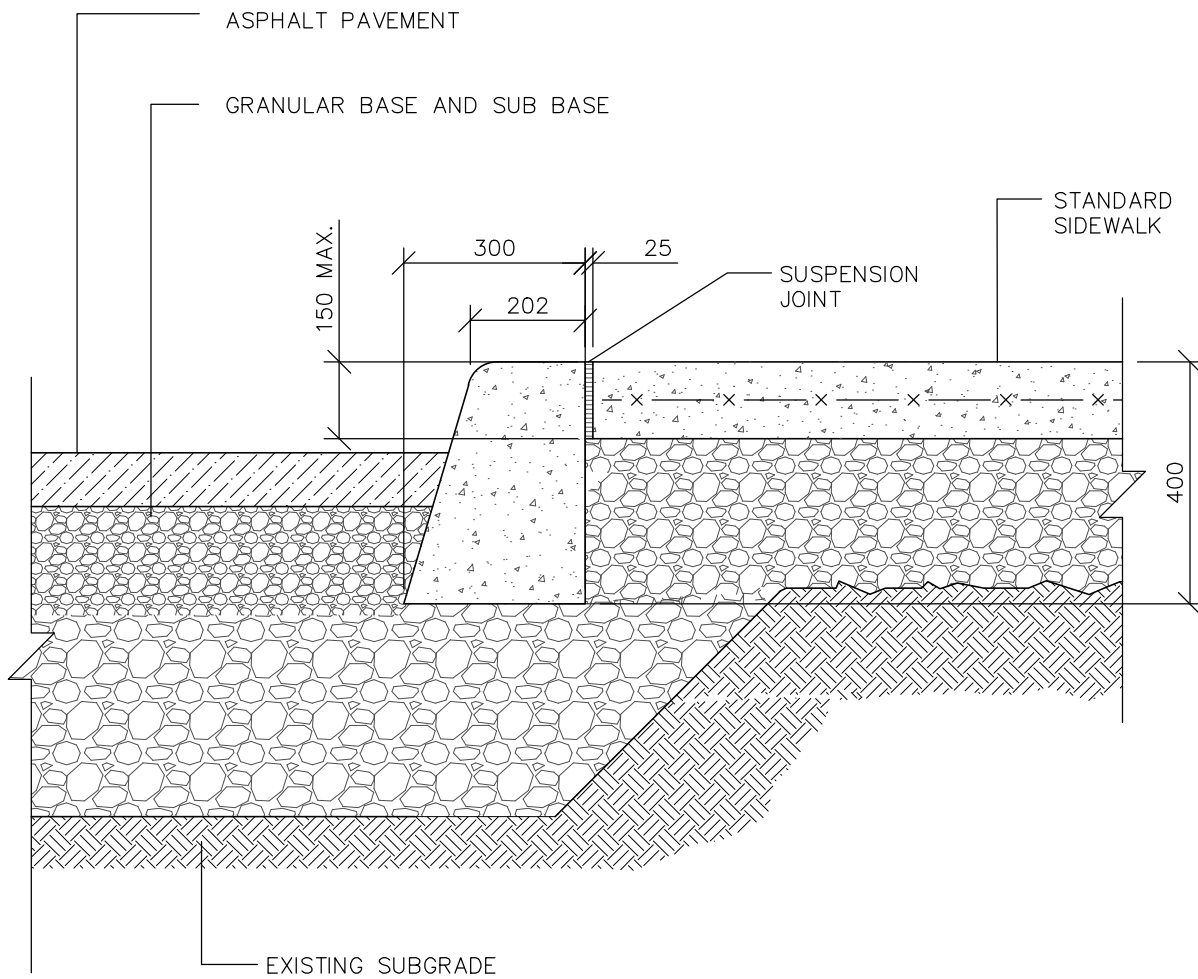

TYPICAL STANDARD CURB  
AT SIDEWALK

SCALE: N.T.S.



TITLE: TYPICAL STANDARD CURB  
AT SIDEWALK

NOTE: NO REPRODUCTION OR USE OF THIS DRAWING IS  
AUTHORIZED WITHOUT EXPRESSED WRITTEN CONSENT  
©COPYRIGHT 2015 IRC BUILDING SCIENCES GROUP INC.

IRC #: —

W.O. #: —

DRN. BY: C.N.P.

CHK. BY: M.M.

SCALE: N.T.S.

DATE: APR. 10/15

DWG.#: 2AC11

M:\ADMIN\BUILDINGS\DETAILS\2\_PARKING\_REHABILITATION\AC-ASPHALT CONC\2AC12 - SPEED BUMP.DWG

NOTES:

1. ASPHALT TO BE USED FOR SPEED BUMP
2. SPEED BUMP TO BE RECESSED 50mm (KEYED INTO ASPHALT).
3. SS1 TACK COAT BETWEEN KEY AND NEW SPEED BUMP ASPHALT.
4. ROUT AND PROVIDE SEALANT AT PERIMETERS.

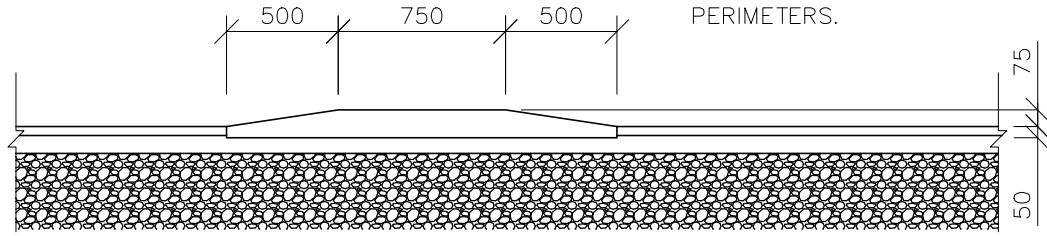

CROSS SECTION

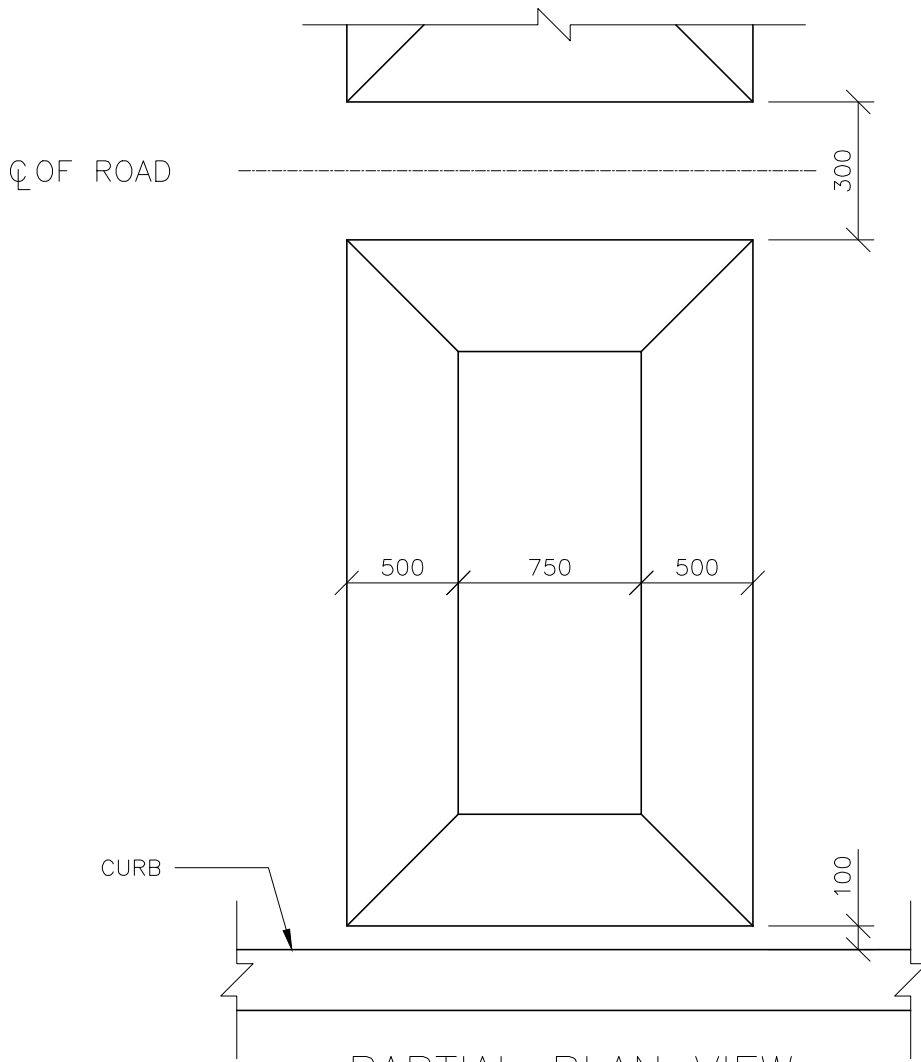

PARTIAL PLAN VIEW



TITLE: TYPICAL SPEED BUMP  
PLAN AND SECTION DETAIL

NOTE: NO REPRODUCTION OR USE OF THIS DRAWING IS  
AUTHORIZED WITHOUT EXPRESSED WRITTEN CONSENT  
©COPYRIGHT 2015 IRC BUILDING SCIENCES GROUP INC.

IRC #: -

W.O. #: -

DRN. BY: T.R.V

CHK. BY: M.M.

SCALE: N.T.S.

DATE: MAY 5/2015

DWG.#: 2AC12

M:\ADMIN\BUILDINGSCIENCE\DETAILS\2\_PARKING\_REHABILITATION\AC- ASPHALT CONC\2AC13 - STEEL BOLLARD.DWG

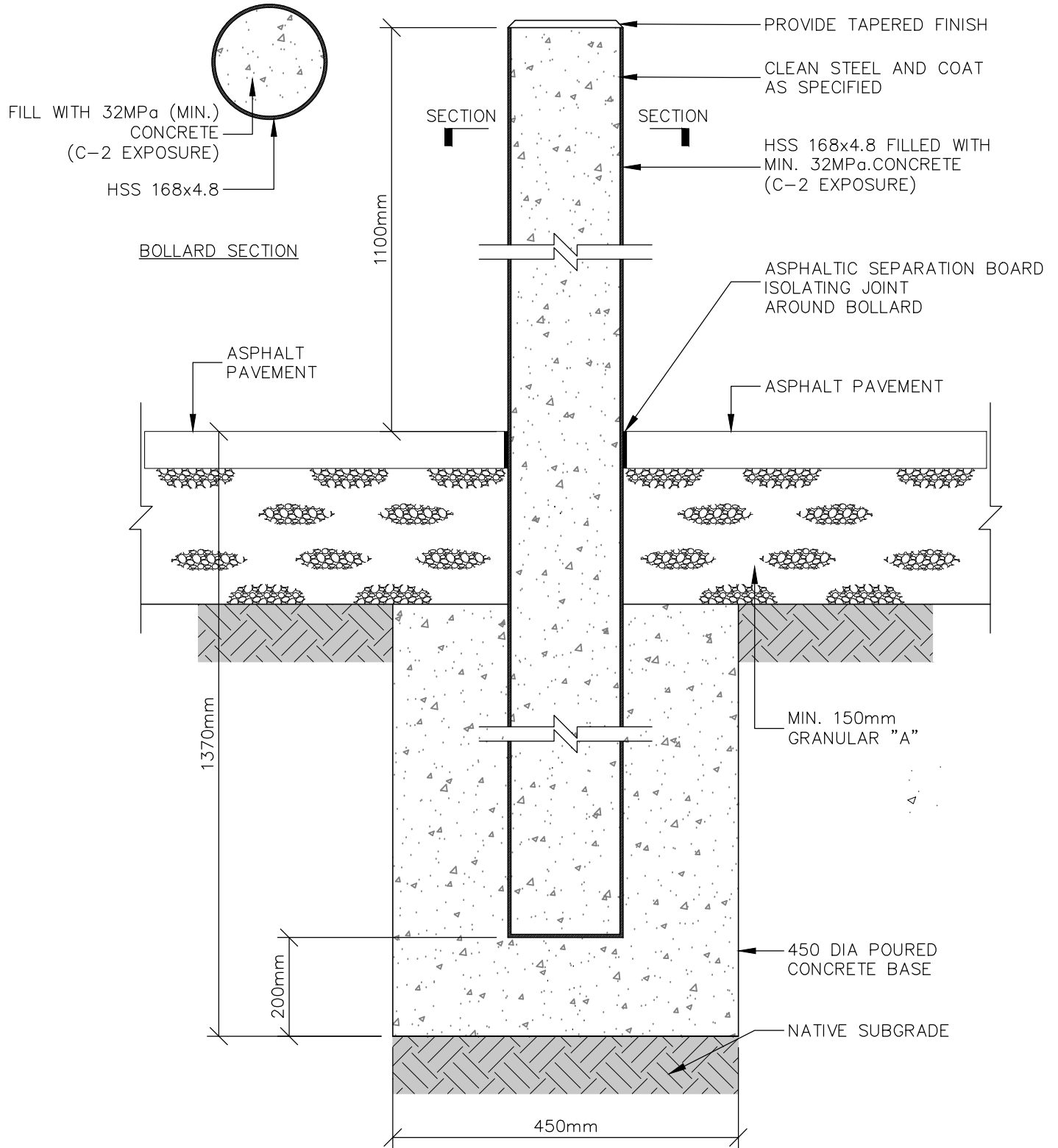

TITLE: STEEL BOLLARD DETAIL

NOTE: NO REPRODUCTION OR USE OF THIS DRAWING IS AUTHORIZED WITHOUT EXPRESSED WRITTEN CONSENT  
©COPYRIGHT 2015 IRC BUILDING SCIENCES GROUP INC.

IRC #: -

W.O. #: -

DRN. BY: T.R.V.

CHK. BY: M.M.

SCALE: N.T.S.

DATE: JUNE 2015

DWG.#: 2AC13