

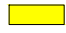

	EXISTING GRAVEL AREA		EXISTING CATCH BASIN
	EXISTING SPEED BUMPS		STEEL BOLLARDS
	PROPOSED CONCRETE RAMP		HANDICAP PARKING



IRC BUILDING SCIENCES GROUP
 SERVING CANADA WITH REGIONAL OFFICES FROM COAST TO COAST
 HEAD OFFICE
 2121 ARGENTIA ROAD, SUITE 401, MISSISSAUGA, ONTARIO
 TOLL FREE: 1-888-607-5245 TEL: 905-607-7244
 WWW.IRCGROUP.COM FAX: 905-607-7288

TITLE: SITE PLAN
 CLIENT: HOUSING SERVICES CORPORATION
 PROJECT: WESTWOOD PLACE
 6550 & 6600 KALAR RD.
 NIAGARA FALLS, ONTARIO

IRC #: 08621
 W.O.#: HA18-178SP
 SCALE: N.T.S.
 DATE: JANUARY 2019

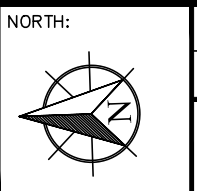

DRN.: R.P.
 CHK.: M.M.
 DWG.#: D1

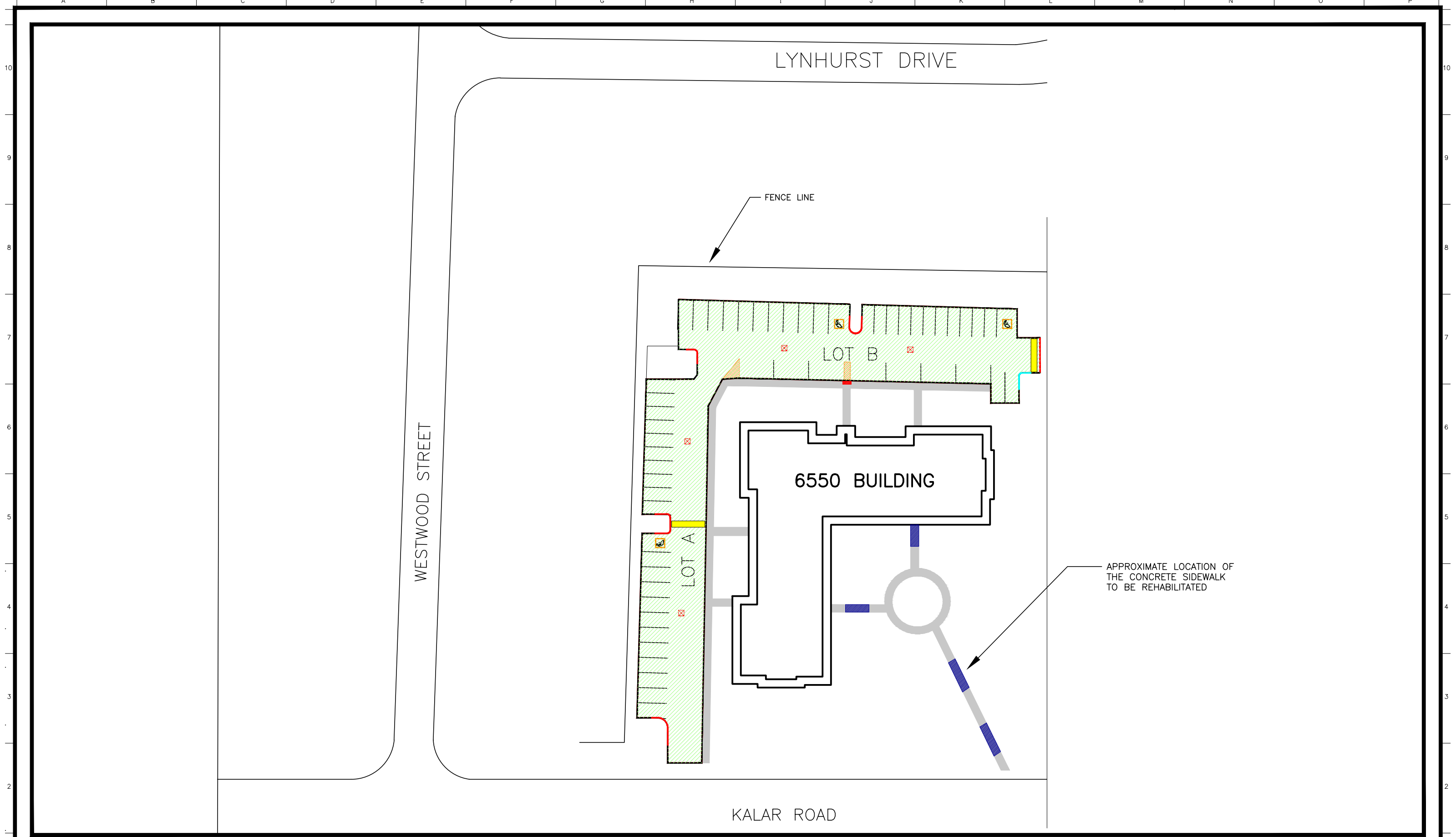

	PROPOSED REHABILITATION ASPHALT AREA (2019)		PROPOSED CONCRETE RAMP
	PROPOSED NEW CONCRETE SIDEWALK		HANDICAP PARKING
	PROPOSED NEW CONCRETE CURBS		EXISTING CATCH BASIN
	EXISTING SPEED BUMPS		



IRC BUILDING SCIENCES GROUP
 SERVING CANADA WITH REGIONAL OFFICES FROM COAST TO COAST
 HEAD OFFICE
 2121 ARGENTIA ROAD, SUITE 401, MISSISSAUGA, ONTARIO
 TOLL FREE: 1-888-607-5245 TEL: 905-607-7244
 WWW.IRCGROUP.COM FAX: 905-607-7288

TITLE:	PROPOSED LOT A & B
CLIENT:	HOUSING SERVICES CORPORATION
PROJECT:	WESTWOOD PLACE 6550 KALAR RD. NIAGARA FALLS, ONTARIO

IRC #:	08621
W.O.#:	HA18-178SP
SCALE:	N.T.S.
DATE:	JANUARY 2019

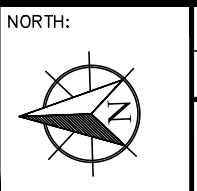







DRN.:	R.P.
CHK.:	M.M.
DWG.#:	D2

LYNHURST DRIVE

KALAR ROAD

6600 BUILDING

APPROXIMATE LOCATION
OF THE PROPOSED
TWO (2) NEW BOLLARDS

	PROPOSED REHABILITATION ASPHALT AREA (2019)		EXISTING CATCH BASIN
	PROPOSED NEW CONCRETE CURBS		STEEL BOLLARDS
	EXISTING SPEED BUMPS		HANDICAP PARKING



IRC BUILDING SCIENCES GROUP
SERVING CANADA WITH REGIONAL OFFICES FROM COAST TO COAST
HEAD OFFICE
2121 ARGENTIA ROAD, SUITE 401, MISSISSAUGA, ONTARIO
TOLL FREE: 1-888-607-5245 TEL: 905-607-7244
WWW.IRCGROUP.COM FAX: 905-607-7288

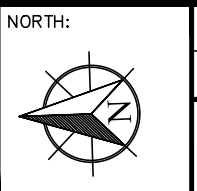

TITLE: PROPOSED LOT C, D & E
CLIENT: HOUSING SERVICES CORPORATION
PROJECT: WESTWOOD PLACE
6600 KALAR RD.
NIAGARA FALLS, ONTARIO

IRC #: 08621
W.O.#: HA18-178SP
SCALE: N.T.S.
DATE: JANUARY 2019

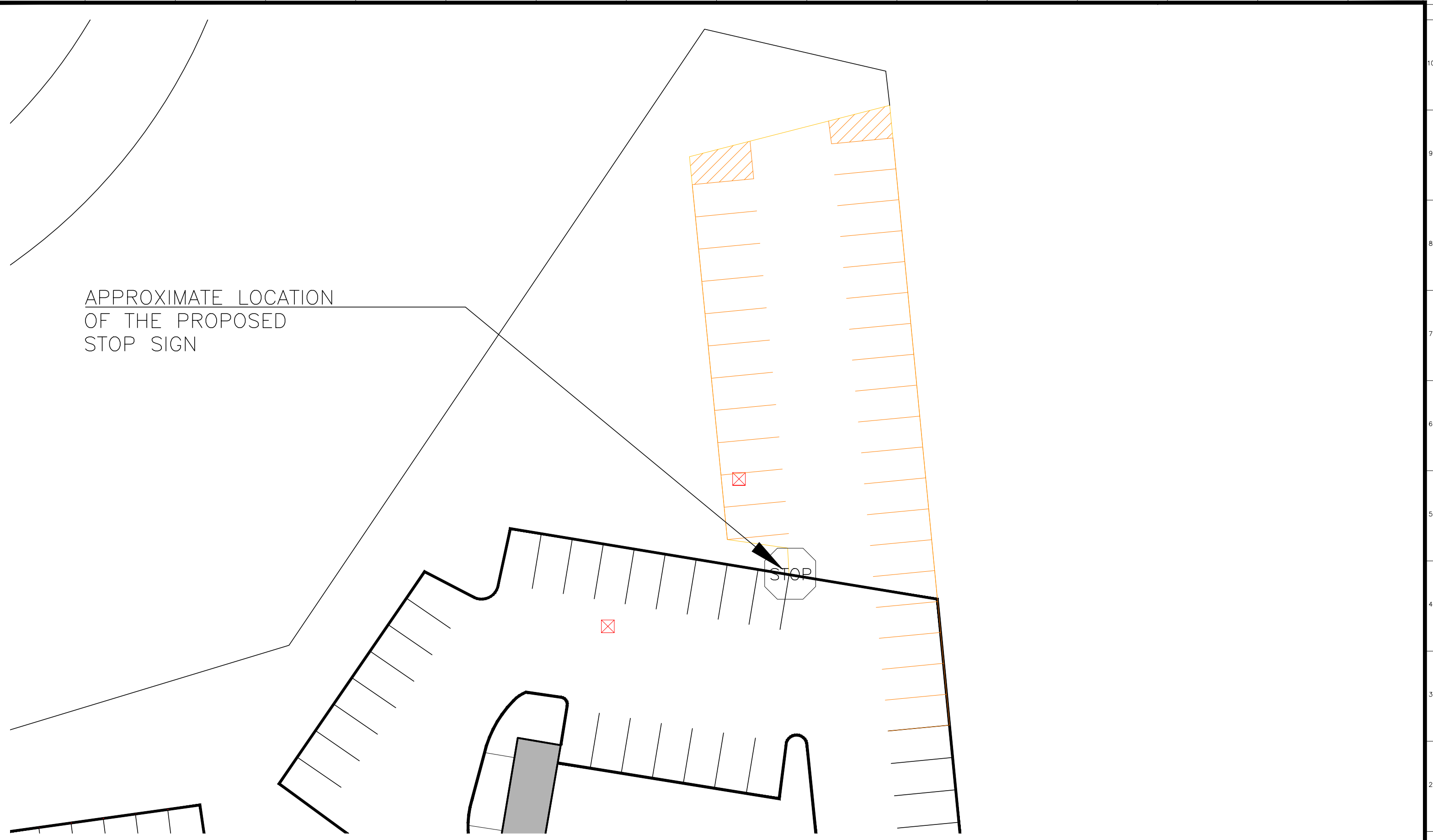

DRN.: R.P.
CHK.: M.M
DWG.#: D3



	PROPOSED SPEED BUMP
	EXISTING CATCH BASIN



IRC BUILDING SCIENCES GROUP
 SERVING CANADA WITH REGIONAL OFFICES FROM COAST TO COAST
 HEAD OFFICE
 2121 ARGENTIA ROAD, SUITE 401, MISSISSAUGA, ONTARIO
 TOLL FREE: 1-888-607-5245 TEL: 905-607-7244
 WWW.IRCGROUP.COM FAX: 905-607-7288

TITLE: PROPOSED GRAVEL EXPANSION
CLIENT: HOUSING SERVICES CORPORATION
PROJECT: WESTWOOD PLACE
 6600 KALAR RD.
 NIAGARA FALLS, ONTARIO

IRC #: 08621
W.O.#: HA18-178SP
SCALE: N.T.S.
DATE: JANUARY 2019

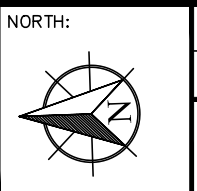

DRN.: R.P.
CHK.: M.M
DWG.#: D4

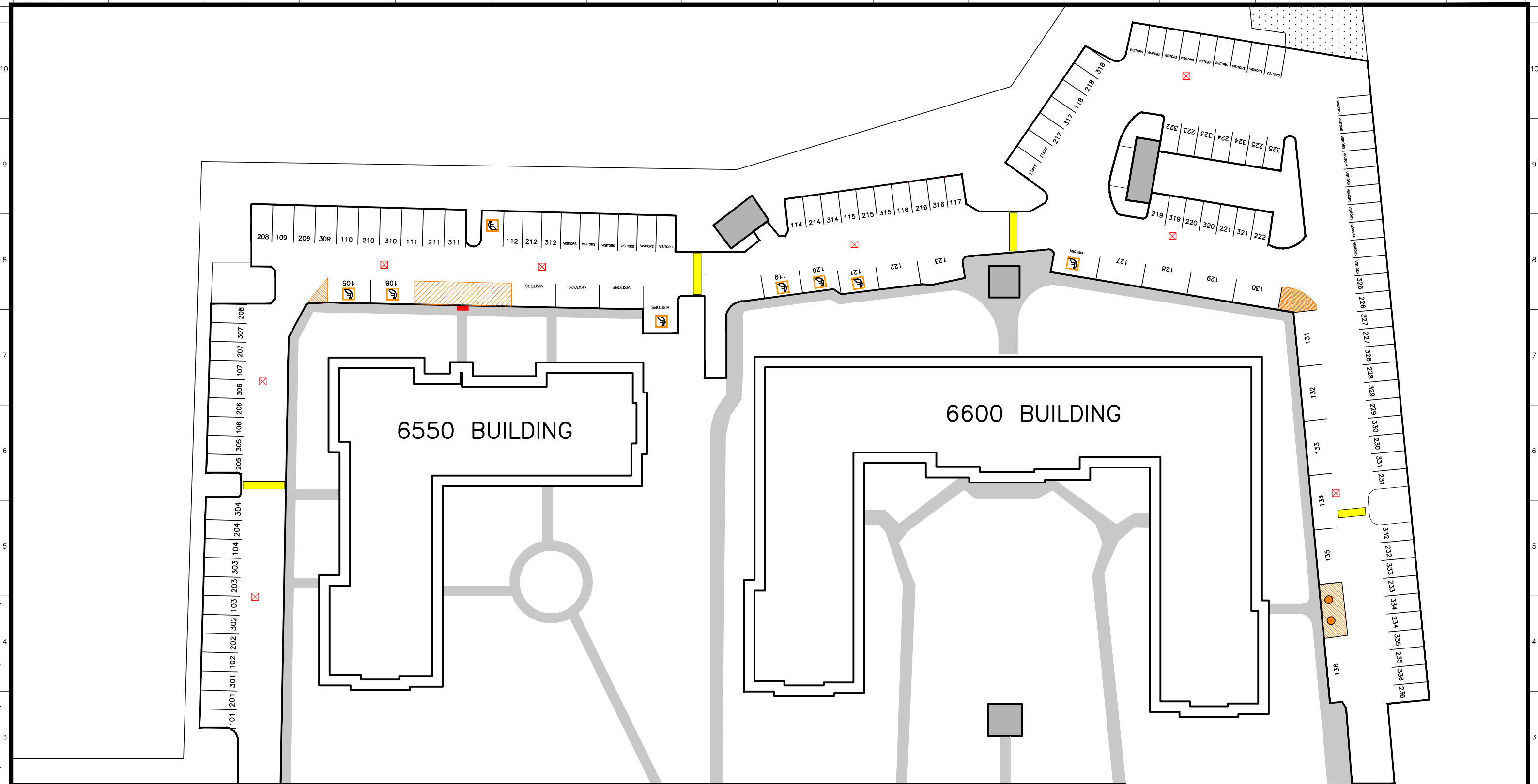

KALAR ROAD

	EXISTING CATCH BASIN
---	----------------------



IRC BUILDING SCIENCES GROUP
 SERVING CANADA WITH REGIONAL OFFICES FROM COAST TO COAST
 HEAD OFFICE
 2121 ARGENTIA ROAD, SUITE 401, MISSISSAUGA, ONTARIO
 TOLL FREE: 1-888-607-5245 TEL: 905-607-7244
 WWW.IRCGROUP.COM FAX: 905-607-7288

TITLE:	SITE PLAN
CLIENT:	HOUSING SERVICES CORPORATION
PROJECT:	WESTWOOD PLACE 6600 KALAR RD. NIAGARA FALLS, ONTARIO

IRC #:	08621
W.O.#:	HA18-178SP
SCALE:	N.T.S.
DATE:	JANUARY 2019

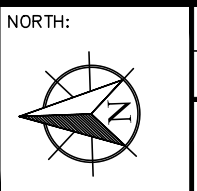

DRN.:	R.P.
CHK.:	M.M
DWG.#:	D5

M:\ADMIN\BUILDINGSCIENCE\DETAILS\2_PARKING_REHABILITATION\AC ASPHALT CONC\2AC06.DWG

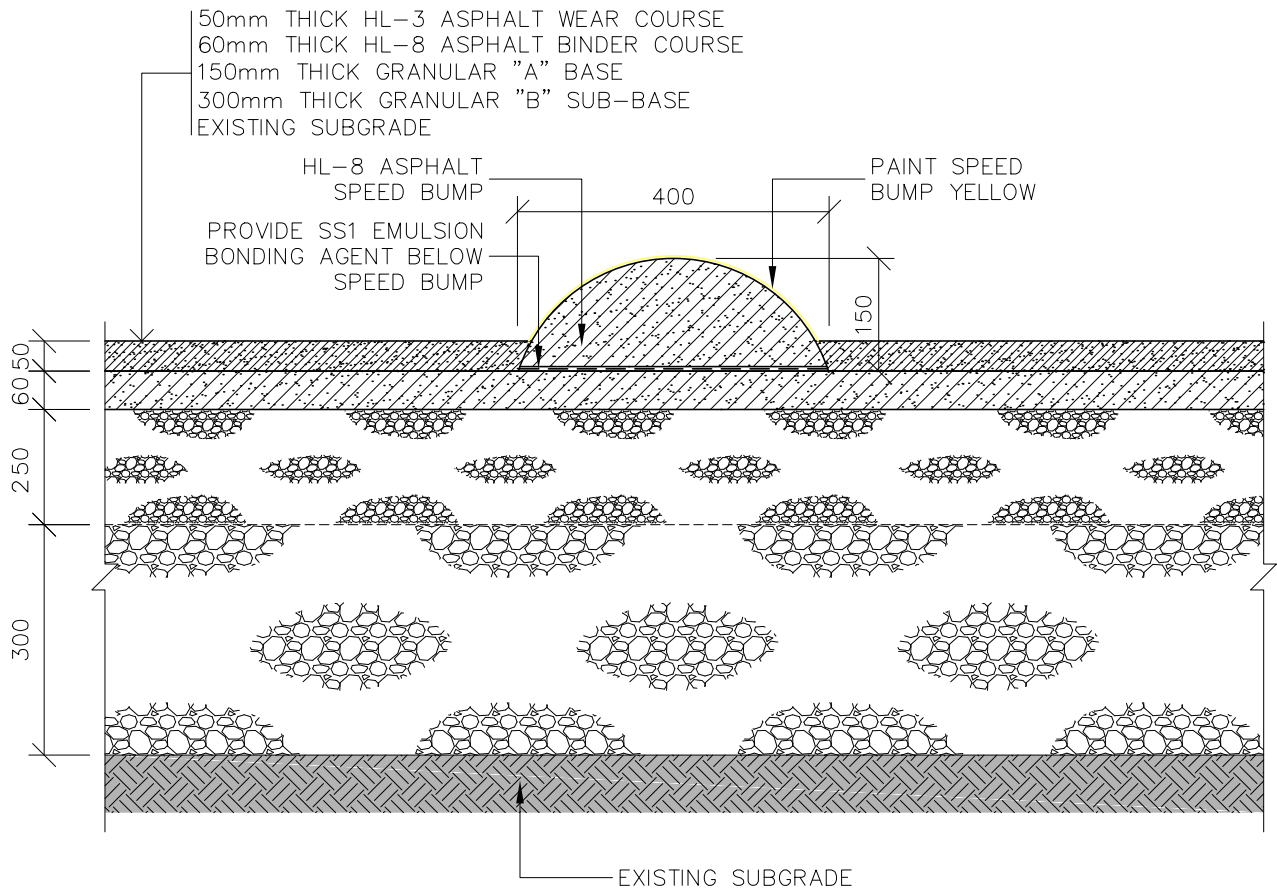

TITLE: TYPICAL SPEED BUMP SECTION DETAIL

NOTE: NO REPRODUCTION OR USE OF THIS DRAWING IS AUTHORIZED WITHOUT EXPRESSED WRITTEN CONSENT
 ©COPYRIGHT 2009 IRC BUILDING SCIENCES GROUP INC.

IRC # —
 W.O. # —
 DRN. BY: F.Z.
 CHK. BY: C.M.B.

SCALE: N.T.S.
 DATE: SEP. 17/09
 DWG.# 2AC06

\\IRC-PR-FST\USERS\RLAUGHLIN\DESKTOP\X-SECTION DETAILS\CAD DETAILS\2AC07_MODIFIED.DWG

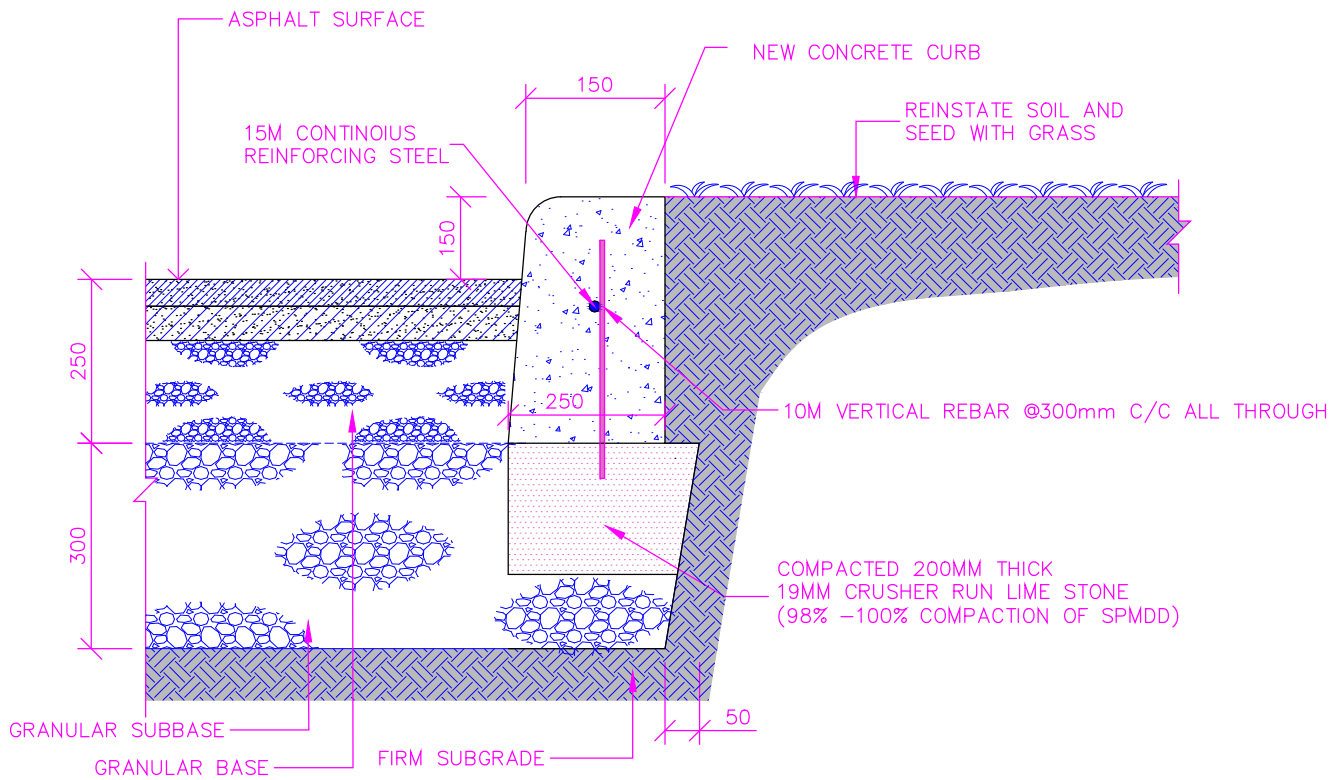

TITLE: NEW CONCRETE CURB DETAIL

IRC #: —

SCALE: N.T.S.

W.O. #: —

DATE: NOV. 18/2015

NOTE: NO REPRODUCTION OR USE OF THIS DRAWING IS AUTHORIZED WITHOUT EXPRESSED WRITTEN CONSENT ©COPYRIGHT 2009 IRC BUILDING SCIENCES GROUP INC.

DRN. BY: M.H.

DWG.#: 2AC07

CHK. BY: M.M.

M:\ADMIN\BUILDINGSCIENCE\DETAILS\2_PARKING_REHABILITATION\AC ASPHALT CONC\2AC09.DWG

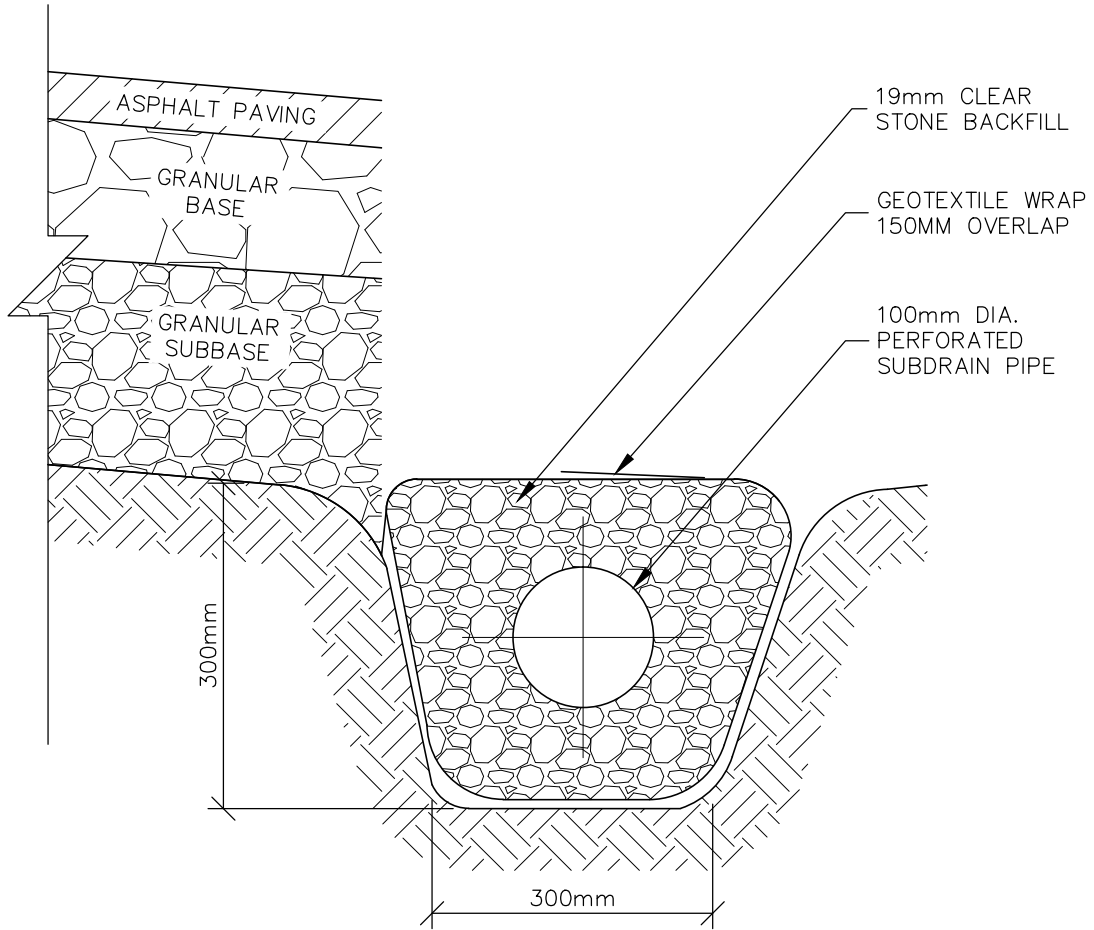

SECTION DETAIL
PAVEMENT SUBDRAIN

SCALE: N.T.S.

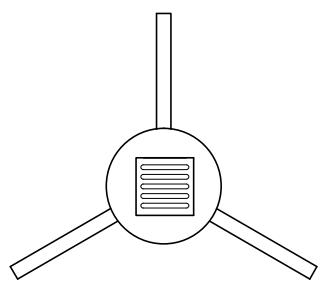

PLAN DETAIL
AREA CATCH BASIN
SCALE: N.T.S.

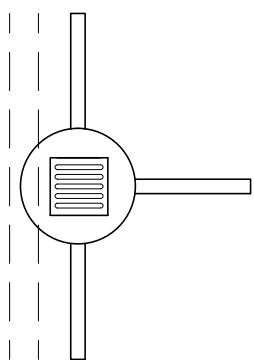

PLAN DETAIL
CATCH BASIN AT CRUB
SCALE: N.T.S.

- NOTES:
1. PLACE 100mm DIAMETER PERFORATED SUBDRAIN PIPE SURROUNDED BY 20mm CLEAR CRUSHED STONE AND WRAPPED IN FILTER CLOTH.
 2. SUBDRAINS TO BE INSTALLED AT MINIMUM 0.5 PERCENT GRADE AND CONNECT TO POSITIVE OUTLET (I.E. DITCH OR CATCHBASIN); UNIT PRICE TO INCLUDE TEE CONNECTIONS.



NOTE: NO REPRODUCTION OR USE OF THIS DRAWING IS AUTHORIZED WITHOUT EXPRESSED WRITTEN CONSENT ©COPYRIGHT 2015 IRC BUILDING SCIENCES GROUP INC.	TITLE:	NEW SUBDRAIN DETAIL	IRC #:	—	SCALE:	N.T.S.
			W.O. #:	—	DATE:	JAN. 09/15
			DRN. BY:	C.N.P.	DWG.#:	2AC09
			CHK. BY:	M.M.		

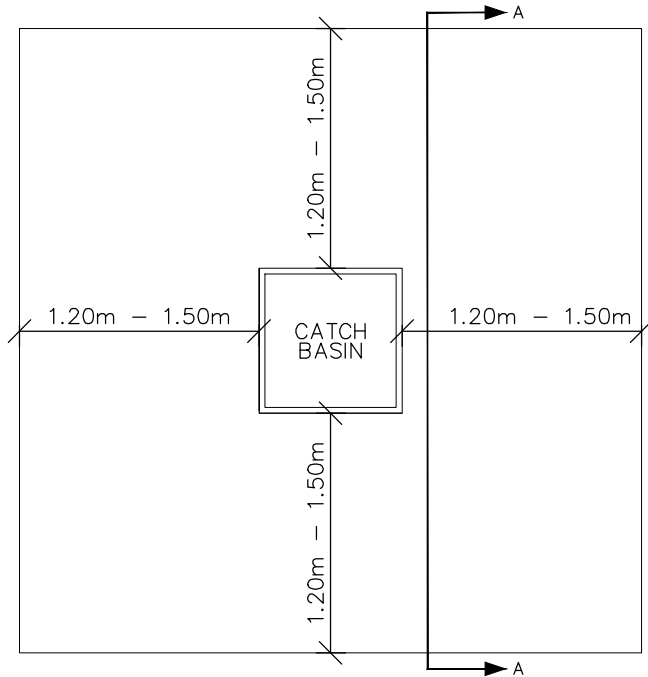

PLAN DETAIL
FROST TREATMENT AREA

SCALE: N.T.S.

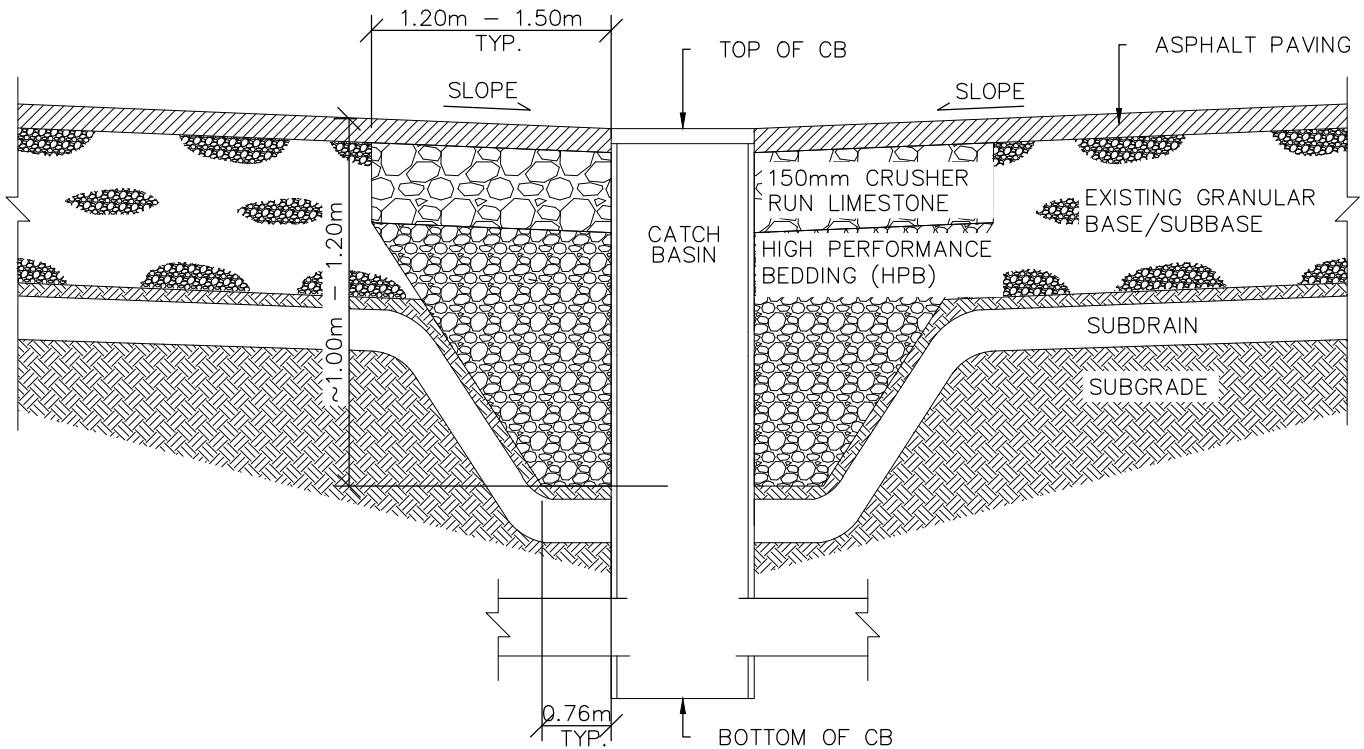

SECTION A - A DETAIL
FROST TREATMENT AREA

SCALE: N.T.S.

M:\ADMIN\BUILDINGSCIENCE\DETAILS\2_PARKING_REHABILITATION\AC ASPHALT_CONC\2AC10.DWG



TITLE: CATCHBASIN FROST
TREATMENT DETAIL

NOTE: NO REPRODUCTION OR USE OF THIS DRAWING IS
AUTHORIZED WITHOUT EXPRESSED WRITTEN CONSENT
©COPYRIGHT 2015 IRC BUILDING SCIENCES GROUP INC.

IRC #: —

W.O. #: —

DRN. BY: C.N.P.

CHK. BY: M.M.

SCALE: N.T.S.

DATE: JAN. 09/15

DWG.#: 2AC10

M:\ADMIN\BUILDINGSCIENCE\DETAILS\2_PARKING_REHABILITATION\AC ASPHALT CONC\2AC11.DWG

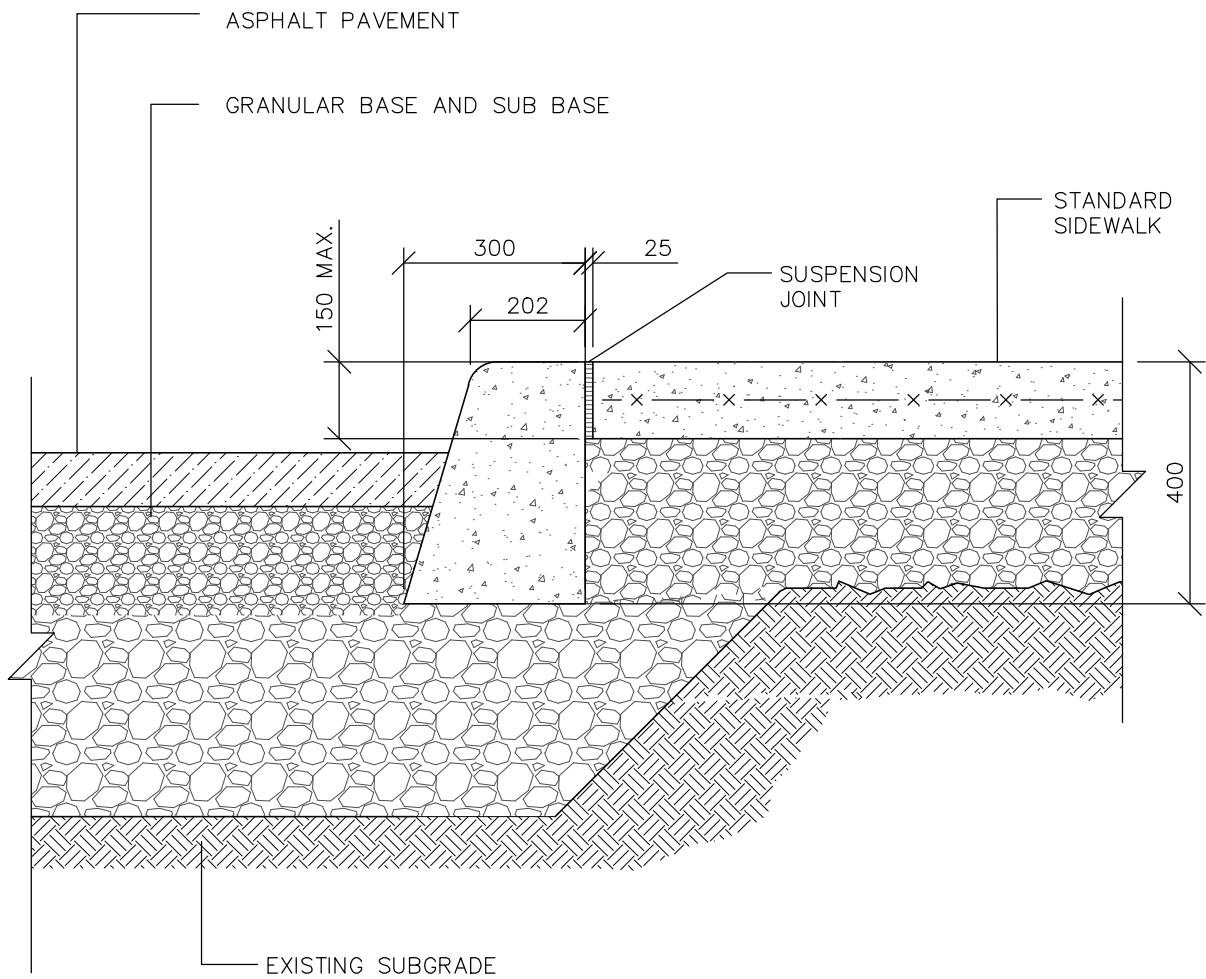

TYPICAL STANDARD CURB
AT SIDEWALK

SCALE: N.T.S.



TITLE: TYPICAL STANDARD CURB
AT SIDEWALK

NOTE: NO REPRODUCTION OR USE OF THIS DRAWING IS
AUTHORIZED WITHOUT EXPRESSED WRITTEN CONSENT
©COPYRIGHT 2015 IRC BUILDING SCIENCES GROUP INC.

IRC #: —

W.O. #: —

DRN. BY: C.N.P.

CHK. BY: M.M.

SCALE: N.T.S.

DATE: APR. 10/15

DWG.#: 2AC11

M:\ADMIN\BUILDINGS\DETAILS\2_PARKING_REHABILITATION\AC-ASPHALT CONC\2AC12 - SPEED BUMP.DWG

NOTES:

1. ASPHALT TO BE USED FOR SPEED BUMP
2. SPEED BUMP TO BE RECESSED 50mm (KEYED INTO ASPHALT).
3. SS1 TACK COAT BETWEEN KEY AND NEW SPEED BUMP ASPHALT.
4. ROUT AND PROVIDE SEALANT AT PERIMETERS.

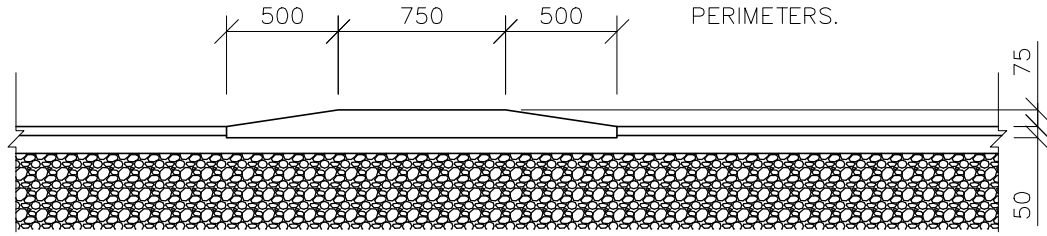

CROSS SECTION

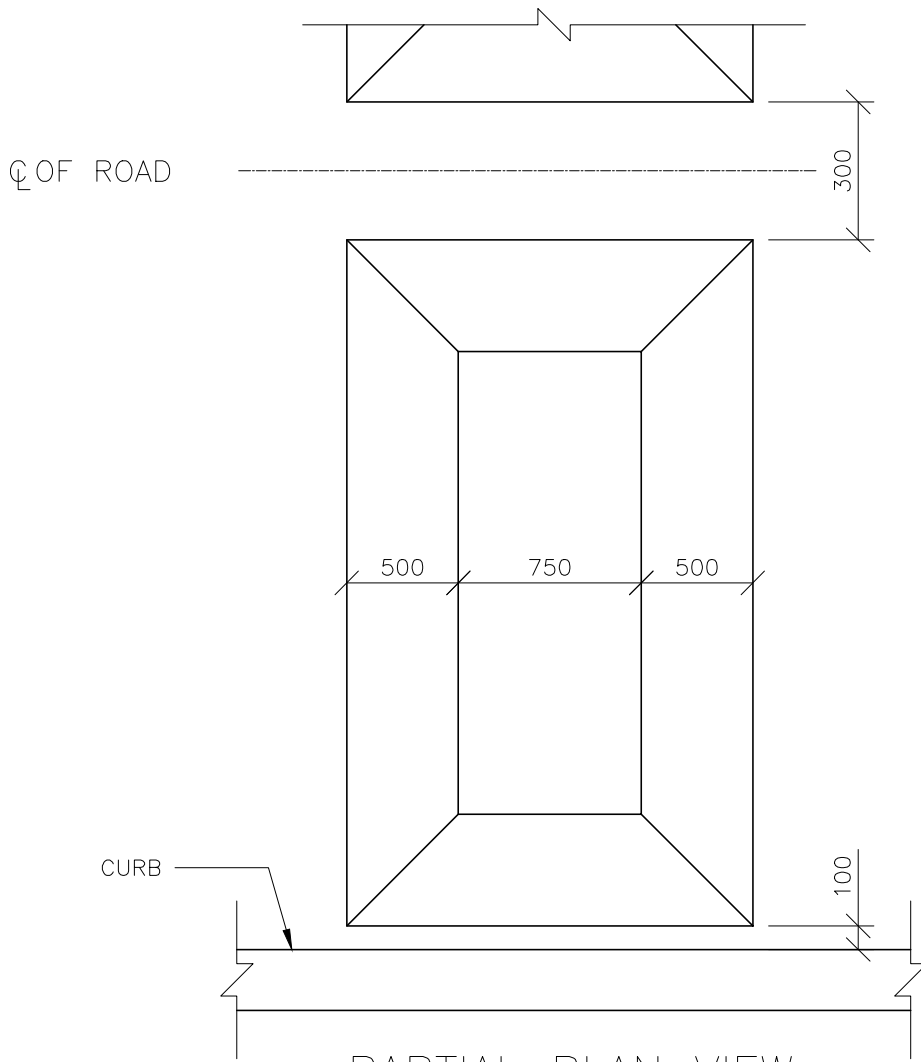

PARTIAL PLAN VIEW



TITLE: TYPICAL SPEED BUMP
PLAN AND SECTION DETAIL

NOTE: NO REPRODUCTION OR USE OF THIS DRAWING IS
AUTHORIZED WITHOUT EXPRESSED WRITTEN CONSENT
©COPYRIGHT 2015 IRC BUILDING SCIENCES GROUP INC.

IRC #: -

W.O. #: -

DRN. BY: T.R.V

CHK. BY: M.M.

SCALE: N.T.S.

DATE: MAY 5/2015

DWG.#: 2AC12

M:\ADMIN\BUILDINGSCIENCE\DETAILS\2_PARKING_REHABILITATION\AC-ASPHALT_CONC\2AC13 - STEEL BOLLARD.DWG

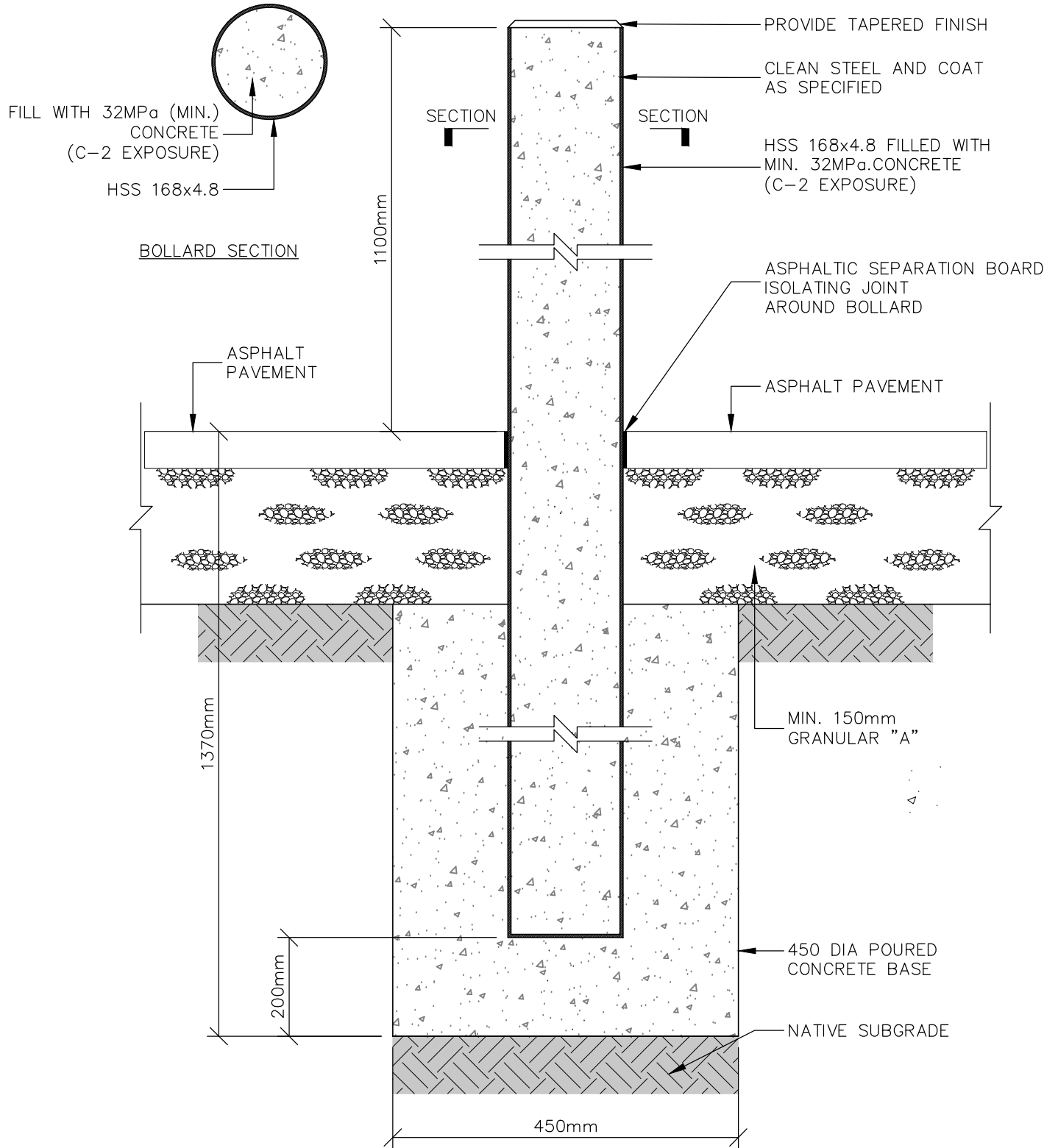

TITLE: STEEL BOLLARD DETAIL

NOTE: NO REPRODUCTION OR USE OF THIS DRAWING IS AUTHORIZED WITHOUT EXPRESSED WRITTEN CONSENT
©COPYRIGHT 2015 IRC BUILDING SCIENCES GROUP INC.

IRC #: -

W.O. #: -

DRN. BY: T.R.V.

CHK. BY: M.M.

SCALE: N.T.S.

DATE: JUNE 2015

DWG.#: 2AC13

M:\BUILDINGSCIENCE\CAD BUILDING SCIENCES\DETAILS\2_PARKING_REHABILITATION\AC ASPHALT CONC\NEW CONCRETE PAD-SIDEWALK DETAIL\SLAB DETAIL.DWG

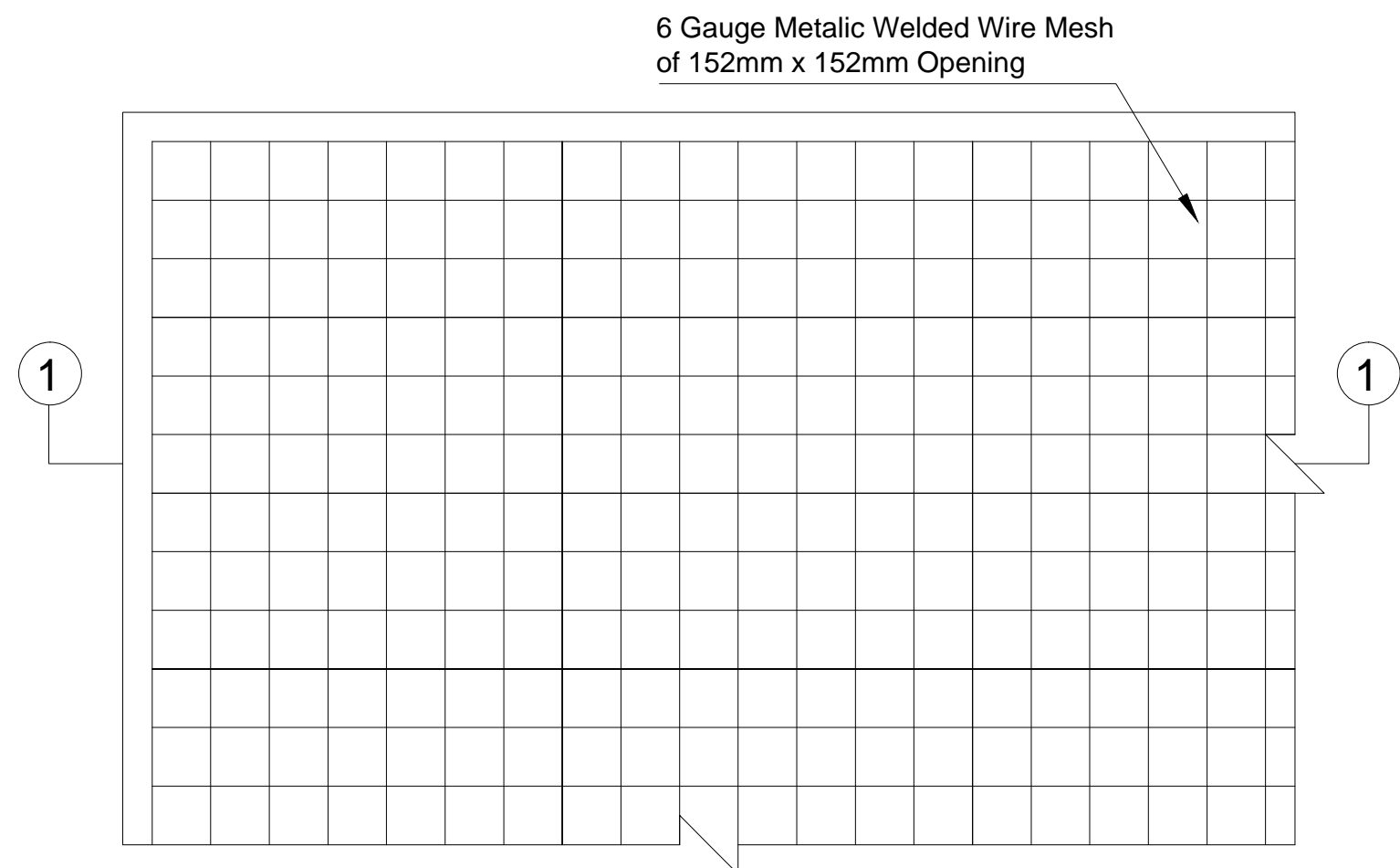
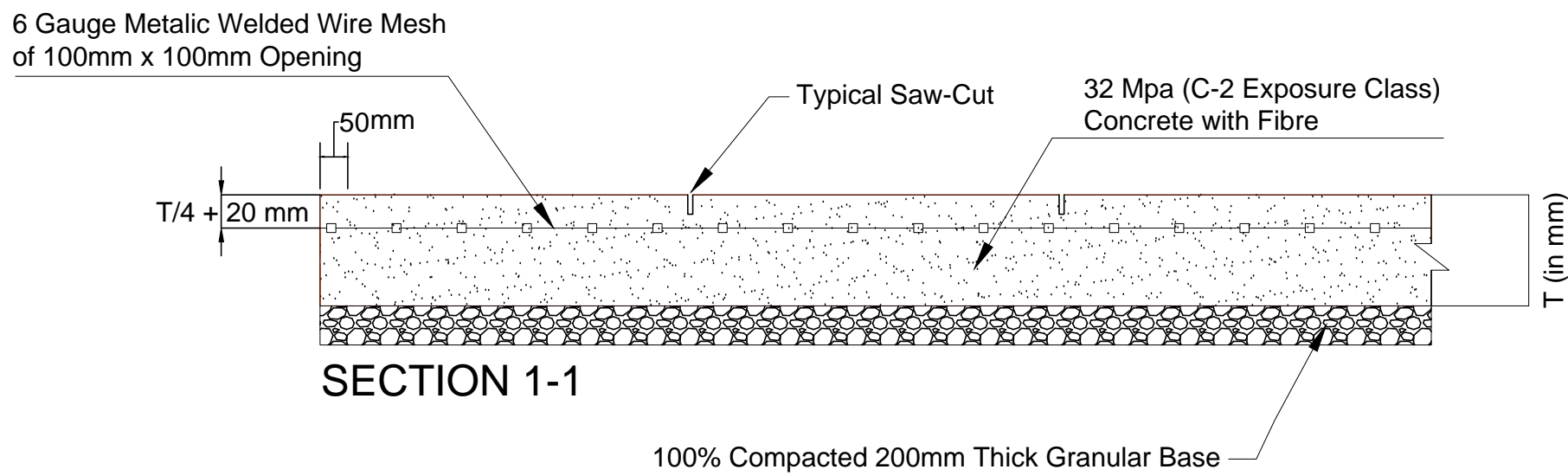

Note: the depth of the Saw Cut should not be more than 1/4 of the Thickness (T) of Sidewalk.



IRC BUILDING SCIENCES GROUP
 SERVING CANADA WITH REGIONAL OFFICES FROM COAST TO COAST
 HEAD OFFICE
 2121 ARGENTIA ROAD, SUITE 401, MISSISSAUGA, ONTARIO
 TOLL FREE: 1-888-607-5245 TEL: 905-607-7244
 WWW.IRCGROUP.COM FAX: 905-607-7288

TITLE:	NEW SIDEWALK DETAIL
CLIENT:	-
PROJECT:	-

IRC #:	-
W.O.#:	-
SCALE:	1:500
DATE:	JULY 2017

NORTH:	
--------	--

DRN.:	M.A.
CHK.:	M.M.
DWG.#:	2AC02-A